

GN 250

Indent blocks

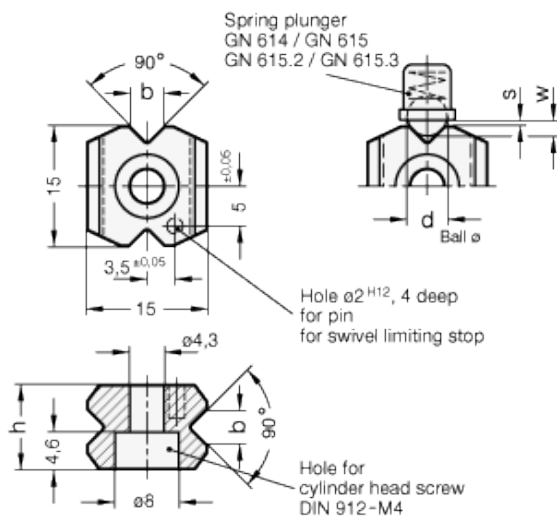

Example of application

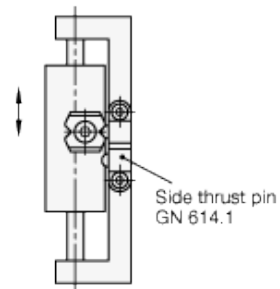

technical informations

Material

Sintered and case-hardened, blank.

Applications

GN 250 indent blocks are used together with ball spring plungers type [GN 614](#), [GN 615](#) and [GN 615.2](#) for detenting or positioning sliding parts, flaps or similar applications.

Application example

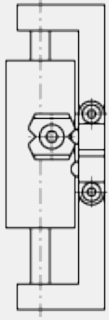

| Standard Elements | Main dimensions | | GN 614 | | | | GN 615 | GN 615.2 | GN 615.3 | Weight | |
|-------------------|-----------------|-------------------|--------|-----|----------------|----------------|--------|----------|----------------|--------|----------------|
| | h | b _{±0.1} | Dim. | d | l ₁ | l ₂ | Dim. | d | l ₁ | | l ₂ |
| GN 250-8.5 | 8.5 | 3.4 | 6 | 5 | 1.6 | 0.9 | M8 | 4.5 | 1.5 | 0.8 | 10 |
| GN 250-10.5 | 10.5 | 4.5 | 8 | 6.5 | 1.9 | 1 | M10 | 6 | 2 | 1 | 11 |



ELESA and GANTER models all rights reserved in accordance with the law. Always mention the source when reproducing our drawings.

STANDARD MACHINE ELEMENTS WORLDWIDE